

## Purify Solo 10 FS

Article no: WS-40-1910-10-WP

## Purify Solo 20 FS

Article no: WS-40-1920-10-WP

## Purify Solo 40 FS

Article no: WS-40-1940-10-WP

### PRODUCT DESCRIPTION

Purify Solo FS is designed and produced in Sweden, with high quality, versatility, small footprint and cost efficiency in mind.

The Purify Solo FS is a retro-fit solution, to enable use of our Purify Solo range as a stand alone unit where full integration is not possible.

Thanks to an external flow sensor and a small electronics box the LEDs are automatically powered on when water flow is detected. The LEDs unlike other sources of UV-light immediately gives full output effect, hence the water will be disinfected from the moment the water starts to flow.

The electronics box also features indicator LEDs that will tell you when the system is powered on, and when the Purify Solo disinfection is active.

The reduction of harmful microorganisms can reach up to 99,9999%.\*

\*For specific strains of bacteria at a specified flow rate depending on the version of Purify Solo.

Our patented system consists of a reactor where flowing water is exposed to UV-C light. Purify Solo FS has a combination of design, materials, mechanics and fluid dynamics to optimize the use of the UVC light and thereby achieve maximum disinfection performance.

The Purify Solo FS is designed for installation as close to point of use as possible to minimize the risk of contamination from pipes inside/outside the premises.

Easy installation means lower installation costs, and ease of service, if needed.



### AREAS OF USE (Examples)



#### Residential:

Taps & faucets, Showers

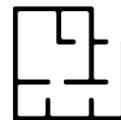

#### Commercial:

Water dispensers, Misting systems, Ice makers



#### Transportation:

Marine, RV, Rail



#### Healthcare:

Dental water, Dialysis water, Medical devices



#### Remote/Mobile:

Emergency response, Aid, Defence

## PRODUCT HIGHLIGHTS

- Compact design
- Easy integration
- Swedish quality
- External materials chosen to convey internal quality
- Energy efficient
- No harmful materials or chemicals
- Inline inlet/outlet for easy installation
- Can be retrofitted to existing products

## FEATURES

### Functionality

- Dose delivery:  
Solo 10 – RED 10 mJ/cm<sup>2</sup> @4,5 l/min\*  
Solo 20 – RED 10 mJ/cm<sup>2</sup> @7,5 l/min\*  
Solo 40 – RED 10 mJ/cm<sup>2</sup> @ 13,5 l/min\*  
\* Calculated performance
- LED life span ≤5 000 h active time
- No maintenance
- Automatic On/Off with water flow

### Environment

- Water temperature 0-45 °C while active (high water temperature may reduce life span)
- Air temperature 0-45 °C
- Working pressure 8 bar
- IPX3 classification

### Electrical

- Wall-plug to DC-contact adapter included (230 VAC to 12 VDC)
- Optional: Power cable for 12VDC connection
- External status signal LED  
– Green indicates Power  
– Blue indicates Disinfection

### Regulatory

- CE marking
- NSF/ANSI 55 class B certification in progress
- WRAS certification in progress
- All materials in contact with water are KTW-BWGL compliant
- Accredited third-party validation

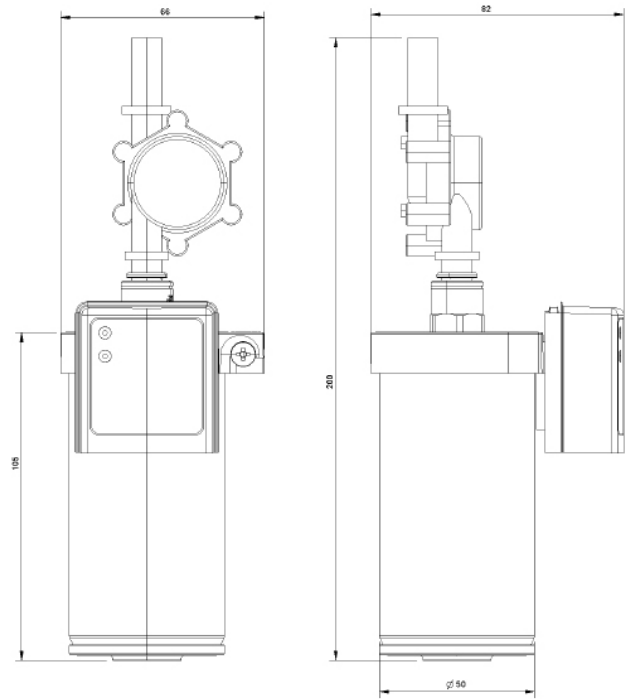

## DIMENSIONS

### Weight

Solo 10/20	320 g
Solo 40	380 g

### Installation length

Solo 10/20	200 mm
Solo 40	260 mm

### Diameter

50 mm

## CONNECTIONS

As standard the unit is delivered with the following configuration:

**Inlet:** ¼" threaded female (ISO G8)

**Outlet:** ⅜" male for push-fit connection (e.g., John-Guest)  
Adapter to different type or size connection available upon request.

## PACKAGING

Products are delivered with power adapter for 230V outlet and bracket for installation.

Box quantity	1
Boxed size	290x120x120 mm
Boxed weight	tbd