

Purify Solo 10

Article no: WS-10-1210

Purify Solo 20

Article no: WS-10-1220

Purify Solo 40

Article no: WS-10-1240

PRODUCT DESCRIPTION

Purify Solo is designed and produced in Sweden, with high quality, versatility, small footprint and cost efficiency in mind.

The Purify Solo is designed for full integration in applications like water dispensers, shower panels for public use, boats and others.

Purify Solo will be connected to a control system via e.g., a water pump or solenoid valve, that will power the LEDs at the same time as the water starts flowing. The LEDs unlike other sources of UV-light immediately gives full output effect, hence the water will be disinfected from the moment the water starts to flow.

As an option, the third cable lead in the power cable can be connected to the control system, and will then send an electrical status signal that tell that the Solo is working properly or if there is a malfunction.

The reduction of harmful microorganisms can reach up to 99,9999%.*

*For specific strains of bacteria at a specified flow rate depending on the version of Purify Solo.

Our patented system consists of a reactor where flowing water is exposed to UV-C light. Purify Solo has a combination of design, materials, mechanics and fluid dynamics to optimize the use of the UVC light and thereby achieve maximum disinfection performance.

The Purify Solo is designed for installation as close to the point of use as possible to minimize the risk of contamination from pipes inside/outside the premises.



AREAS OF USE (Examples)



Residential:

Taps & faucets, Showers

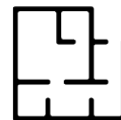

Commercial:

Water dispensers, Misting systems, Ice makers



Transportation:

Marine, RV, Rail



Healthcare:

Dental water, Dialysis water, Medical devices



Remote/Mobile:

Emergency response, Aid, Defence

PRODUCT HIGHLIGHTS

- Compact design
- Easy integration
- Swedish quality
- External materials chosen to convey internal quality
- Energy efficient
- No harmful materials or chemicals
- Inline inlet/outlet for easy installation
- Can be retrofitted to existing products

FEATURES

Functionality

- Dose delivery:
Solo 10 – RED 10 mJ/cm² @4,5 l/min*
Solo 20 – RED 10 mJ/cm² @7,5 l/min*
Solo 40 – RED 10 mJ/cm² @ 13,5 l/min*
* Calculated performance

- LED life span ≤5 000 h active time
- No maintenance

Environment

- Water temperature 0-45 °C while active (high water temperature may reduce life span)
- Air temperature 0-45 °C
- Working pressure 8 bar
- IPX3 classification

Electrical

- 12 VDC regulated input power
- Connection with 3-core fixed cable (1 meter)
- Optional external status signal

Regulatory

- CE marking
- NSF/ANSI 55 class B certification in progress
- WRAS certification in progress
- All materials in contact with water are KTW-BWGL compliant
- Accredited third-party validation

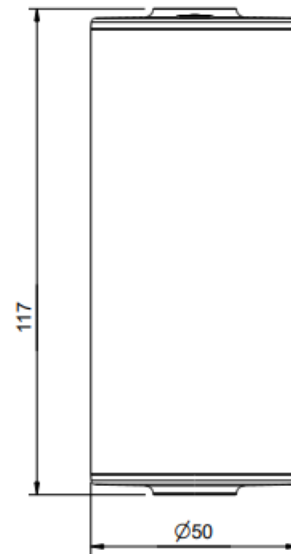

DIMENSIONS

Weight

Solo 10/20	255 g
Solo 40	315 g

Installation length

Solo 10/20	117 mm
Solo 40	167 mm

Diameter

50 mm

CONNECTIONS

As standard the unit is delivered with the following configuration:

Inlet/Outlet: ¼" threaded female (ISO G8)

Adapter to different type or size connection available upon request.

PACKAGING

Products are delivered with power/signal cable and bracket

Box quantity	1
Boxed size	290x120x120 mm
Boxed weight	tbd