

## Purify Mini 06

Article no: WS-10-1106/ WS-10-1106-FS

## Purify Mini 16

Article no: WS-10-1116/ WS-10-1116-FS

### PRODUCT DESCRIPTION

Purify Mini is a low flow disinfection product line, targeted to be integrated in e.g., drinking water products or as an addition to a filter.

Thanks to its compact design, it can be fitted almost everywhere (Point of Use).

Purify Mini is openable so that parts in contact with water can be replaced when needed, this extends product lifetime and is a natural step to more sustainable products. Parts in contact with water are subject to scaling and fouling, which is why at some point they need to be replaced to ensure optimal performance.

A status signal will let you know when it's time to change the optical system. Maintenance kit can be purchased separately.

Purify Mini supports an optional integrated water flow sensor, but can also be activated via an external signal.

Purify Mini can collect a set of data e.g., hours of use, time active, and communicate this via an interface to your device/system.

The reduction of harmful microorganisms can reach up to 99,9999%.\*

\*For specific strains of bacteria at a specified flow rate depending on the version of Purify Mini.

Our patented system consists of a reactor where flowing water is exposed to UV-C light. Purify Mini has a combination of design, materials, mechanics and fluid dynamics to optimize the use of the UVC light and thereby achieve maximum disinfection performance.

The Purify Solo FS is designed for installation as close to point of use as possible to minimize the risk of contamination from pipes inside/outside the premises.



### AREAS OF USE (Examples)



**Residential:**

Taps & faucets, Showers

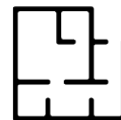

**Commercial:**

Water dispensers, Misting systems, Ice makers



**Transportation:**

Marine, RV, Rail



**Healthcare:**

Dental water, Dialysis water, Medical devices



**Remote/Mobile:**

Emergency response, Aid, Defence

## PRODUCT HIGHLIGHTS

- Easy integration
- Swedish quality
- External materials chosen to convey internal quality
- Energy efficient
- No harmful materials or chemicals
- Inline inlet/outlet for easy installation
- Can be retrofitted to existing products

## FEATURES

### Functionality

- Dose delivery:  
Mini 06 – RED 10 mJ/cm<sup>2</sup> @3 l/min\*  
Mini 16 – RED 10 mJ/cm<sup>2</sup> @6l/min\*  
\* Calculated performance
- Flow rate
  - With integrated flow sensor: 0,5-3 l/min
  - Without integrated flow sensor: 0,5-9 l/min
- LED life span ≤15 000 h active time
- Low maintenance, replaceable optics available
- Automatic On/Off with water flow as an option
- Data logging possible
- WiFi enabled
- External status LED
- Periodical disinfection when inactive

### Environment

- Water temperature 0-50 °C while active (high water temperature may reduce life span)
- Air temperature 0-40 °C
- Working pressure 8 bar
- IPX3 classification

### Electrical

- 24 VDC regulated input power
- Optional: external ON/OFF signal or flow sensor
- External status signal LED
  - Green/Blue/Red/flashing
  - Connection with 5-core power cable (included)

### Regulatory

- CE marking
- All materials in contact with water are KTW-BWGL compliant
- Accredited third-party validation

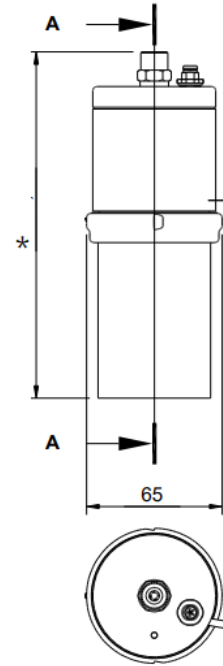

## DIMENSIONS

### Weight

Mini 06	930 g
Mini 16	1310 g

### Installation length

Mini 06	167 mm
Mini 16	267 mm

### Diameter

65 mm

## CONNECTIONS

As standard the unit is delivered with the following configuration:

**Inlet:** ¼" threaded female (ISO G8)

**Outlet:** ¼" threaded male (ISO G8)

Adapter to different type or size connection available upon request.

## PACKAGING

Products are delivered with power/signal cable and bracket

Box quantity	1
Boxed size	290x120x120 mm
Boxed weight	06/16: 1,1/1,5 kg

This document contains information that is subject to change without notice. This document is solely intended for, and may only be used for, the purpose of providing information on solutions produced by Watersprint. This document shall not be deemed a product warranty, whether express or implied. The Watersprint product warranty is solely contained in the purchase agreement with each customer. This document is subject to Watersprint's copyright. No part of this document may be reproduced or transmitted in any form or by any means, or shared with any third party, without the prior written approval of Watersprint. Watersprint products may be protected by one or more patents and by copyright and design rights. "Watersprint" and is a registered trade mark of Watersprint AB. This document does not confer upon the recipient a license to any of Watersprint's intellectual property rights.